

EC

---

75

---

TB

---

Thermally broken robust  
window system for bold  
visual appeal

  
**Thermeco**

Windows for meaningful living.

# EC75TB

EC75TB designed with a commercial look and appeal to include all the features and benefits of Thermeco's unique residential solutions. Thermally broken systems have been designed for improved energy efficiency. Our commitment to environmentally sustainable window solutions delivers you greater comfort of living and increased savings in your heating and cooling costs.

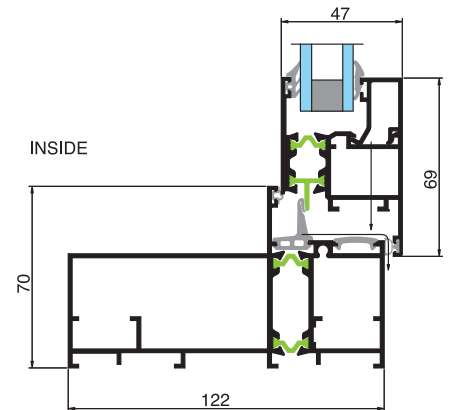

**Frame**

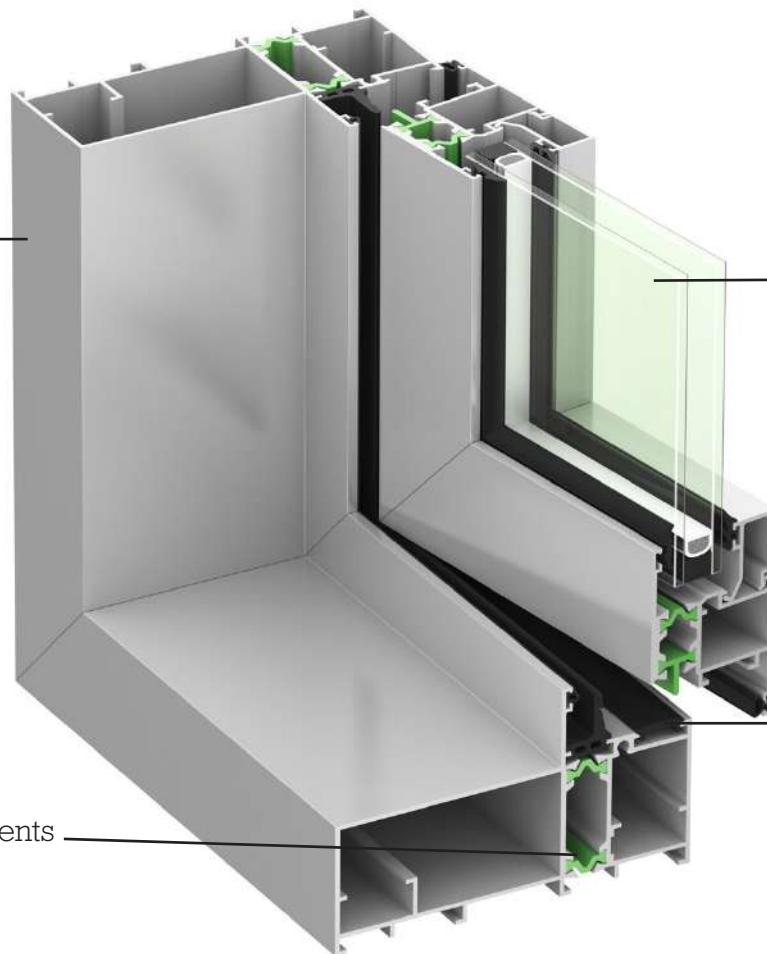

**Single or Double Glazing**

Excellent thermal & acoustic insulation available in a range of up to 32mm thickness to suit installation requirement.

**Gaskets**

Made from EPDM provides initial protection for wind & water penetration.

**Thermal Break**

Effective barrier prevents transmission of heat, cold & noise.

## Opening Styles

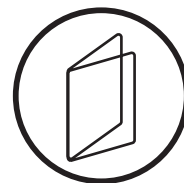
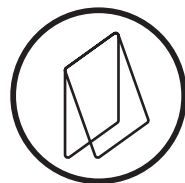
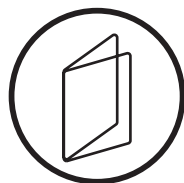
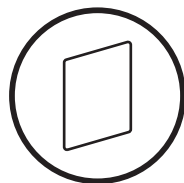

Style	Fixed	Hinged Door	Awning	Casement
Max Width		1000	1700	1200
Max Height	Various	3000	2000	2500
Max Weight (kg)		80	40	80



Architect: Gardiner Architects | Builder: Constructing Spaces







Design: Vibe Design Group | Builder: Icon Synergy



Architect: MGS Architects | Build: Ireland Brown

## Features & Benefits

-  Low maintenance
-  Maximum wind and water tightness
-  Super efficient thermal insulation
-  Increased airflow & greater ventilation control

-  Multi-position locking for added strength & security
-  Energy savings
-  Dual coloured profiles
-  Beauty & design

## Energy Rating WERS



Casement

Fixed

Glazing	Casement		Fixed	
	U	SHGC	U	SHGC
6mm Clear Toughened / 12mm Argon / 6mm Clear Toughened	3.4	0.40	3.0	0.58
6mm Energy Tech / 12mm Argon / 6mm Clear Toughened	3.0	0.35	2.3	0.50
6mm Performa Tech / 12mm Argon / 6mm Clear Toughened	2.9	0.19	2.1	0.26
6mm Insulmax 564 / 12mm Argon / 6mm Clear Toughened	2.9	0.17	2.1	0.23
6mm Sunergy Clear / 12mm Argon / 6mm Clear Toughened	3.1	0.29	2.5	0.42
6.38mm Clear ComfortPlus / 12mm Argon / 6mm Clear Toughened	3.0	0.34	2.3	0.49
6mm LightBridge / 12mm Argon / 6mm Clear Toughened	3.0	0.33	2.2	0.47



Design: Vibe Design Group | Builder: Icon Synergy

# Windows for meaningful living.



Design: Vibe Design Group | Builder: Icon Synergy



Architect: Rachoff Vella | Builder: Marradon Constructions



Architect: Giovani Dambrosio | Build: R&R Van Heek Pty Ltd

## Authorised Fabricator

**Thermeco**  
Windows for meaningful living.

15 Kelletts Road, Rowville  
3178, Victoria, Australia  
Phone: 03 9763 1089  
Fax: 03 9923 6263  
[windows@thermeco.com.au](mailto:windows@thermeco.com.au)

Members of:



\*The images displayed on this brochure may not always exactly relate to the specified series and are used as representation only.